

truss

stacking truss 20.5 spigoted

stacking truss 20.5 spigoted

Standard lengths are 10', 8' and 5'
Custom lengths available on request

Equipped with steel spigot connections
Main chords are 1.90" OD x 3/16" aluminum
Diagonals are 1.5" OD x 1/8" aluminum
Snap Braces provided
Fabricated by certified welders

No. of Sects.	Span ft (mtrs)	Maximum allowable uniform loads			Maximum allowable point loads					
		Load lbs/ft	Load lbs (kgs)	Max Defl. in.	center point		third point		quarter point	
					Load lbs (kgs)	Max Defl. in.	Load lbs (kgs)	Max Defl. in.	Load lbs (kgs)	Max Defl. in.
Spigots Only										
1	5 (1.52)	1069	5345 (2425)	0.00	5349 (2426)	0.01	2674 (1213)	0.01	1783 (809)	0.01
2	10 (3.05)	520	5200 (2359)	0.04	5209 (2363)	0.06	2604 (1181)	0.05	1736 (787)	0.05
3	15 (4.57)	337	5055 (2293)	0.12	5069 (2299)	0.19	2534 (1149)	0.16	1690 (767)	0.15
4	20 (6.10)	246	4920 (2232)	0.28	4744 (2152)	0.43	2464 (1118)	0.38	1643 (745)	0.35
5	25 (7.62)	191	4775 (2166)	0.54	3733 (1693)	0.67	2394 (1086)	0.73	1596 (724)	0.68
6	30 (9.14)	154	4620 (2096)	0.92	3046 (1382)	0.97	2285 (1037)	1.21	1523 (691)	1.13
7	35 (10.69)	128	4480 (2032)	1.44	2546 (1155)	1.32	1910 (866)	1.65	1273 (577)	1.54
8	40 (12.19)	108	4320 (1960)	2.04	2162 (981)	1.67	1622 (736)	2.09	1081 (490)	1.95
9	45 (13.72)	82	3690 (1796)	2.56	1856 (843)	2.12	1392 (631)	2.63	928 (421)	2.46
10	50 (15.24)	63	3150 (1429)	3.08	1595 (724)	2.57	1196 (543)	3.17	797 (362)	2.97

Note: Deflections reported in the above tables are maximum expected for full loadings (indoors only). All loads are based on 10' (3.04 m) sections. Other section lengths are available. Load tables are reprinted from engineering reports developed by Parkhill, Smith & Cooper, Inc., structural engineers, and apply to truss fabricated after December, 1989.

truss

stacking truss 20.5 spigoted

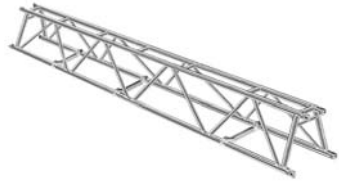

stacking truss 20.5 spigoted
Connections are steel spigots & 5/8" clevis pins

Product Description	Item Code	Weight lbs (kgs)
5-FT STACKING TRUSS	TC 255K-060S	45 (20.4)
8-FT STACKING TRUSS	TC 255K-096S	72 (32.7)
10-FT STACKING TRUSS	TC 255K-120S	90 (40.8)
5/8" CLEVIS PIN	TC CP-625	.25 (.11)
MEDIUM R-CLIP	TC RC-MED	.10 (.04)

PLAN

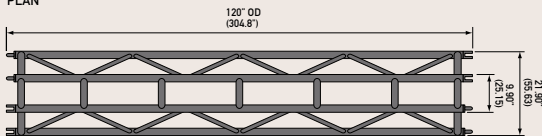

ELEVATION

