

# Triangle truss

## Fixed triangle truss 20.5 spigoted

- › Fixed triangle truss 20.5 spigoted
- › Standard lengths are 10', 8' and 5'
- › Custom lengths available upon request
- › Equipped with steel spigots
- › Main chords are 2" OD x 3/16" aluminum
- › Diagonals are 1" OD x 1/8" aluminum
- › Fabricated by AWS / SFL certified welders



### Plan Views - Connector Orientation Specified by Customer

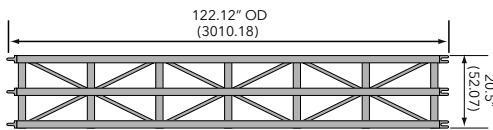

Plan

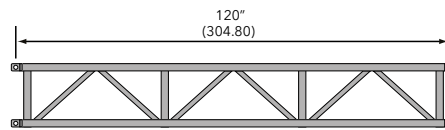

Elevation

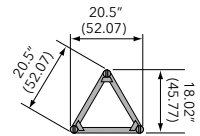

End View

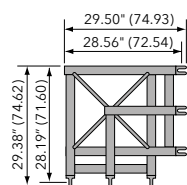

2-Way Corner Block

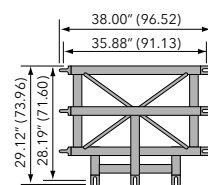

3-Way Corner Block

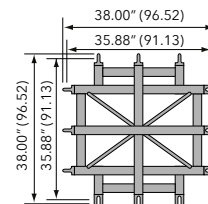

4-Way Corner Block

## Loading chart

Span feet (meters)	Maximum allowable uniform loads			Maximum allowable point loads					
	Load lbs/ft	Load lbs (kgs)	Max Defl. in.	center point Load lbs (kgs)	Max Defl. in.	third point Load lbs (kgs)	Max Defl. in.	quarter point Load lbs (kgs)	Max Defl. in.
10 (3.05)	773	7730 (3506)	0.09	6229 (2825)	0.12	3867 (1754)	0.13	2578 (1169)	0.12
20 (6.09)	246	4920 (2232)	0.49	2468 (1119)	0.40	1851 (840)	0.51	1234 (560)	0.47
30 (9.14)	104	3120 (1415)	1.10	1574 (714)	0.91	1180 (535)	1.14	787 (357)	1.06
40 (12.19)	55	2200 (998)	1.97	1106 (502)	1.64	829 (376)	2.02	553 (251)	1.89
50 (15.24)	32	1600 (726)	3.07	807 (366)	2.60	606 (275)	3.15	404 (183)	2.97

Spigots Only

Note: Deflections reported in the tables on the left are the maximum expected for full loadings (indoor only). All loads are based on 10' (3.05 m) sections. Other section lengths are available. Load tables are reprinted from engineering reports developed by Parkhill, Smith & Cooper, Inc., Structural Engineers, and apply to truss fabricated after December 1989.

## Fixed triangle truss 20.5 spigoted Connections are steel spigots & 3/4" clevis pins

Product Description	Item Code	Weight lbs (kgs)
5FT FOLDING TRIANGLE TRUSS	TC 20FT-060S	55 (25)
8FT FOLDING TRIANGLE TRUSS	TC 20FT-096S	77 (35)
10FT FOLDING TRIANGLE TRUSS	TC 20FT-120S	85 (39)
3/4" CLEVIS PIN	TC CP-75	0.4 (0.18)
MEDIUM R-CLIP	TC RC-MED	- (-)