

Outdoor roof systems

46 x 43 with wings

This roof design, with single tower 20' PA wings, has long been one of the most popular ever offered by TOMCAT, due to its loading capabilities and ease of transportation. Because of its unique construction, including sleeves for the 12" tower that are built into the perimeter grid, the system boasts a total maximum uniform distributed load (UDL) of 16,000 pounds (7,258 kg) and 6,000 pounds (2,722 kg) max. load per wing. It also provides a safe operating wind speed of up to 67 mph. The name of this roof is derived from the outside dimensions of the grid: 43' (13.11 m) deep by 46' (14.02 m) wide. In addition to the ability to erect the system in just a few hours, the entire system easily fits into a mid-sized truck. The system is shown here without the guy wires that are required for outdoor installations.

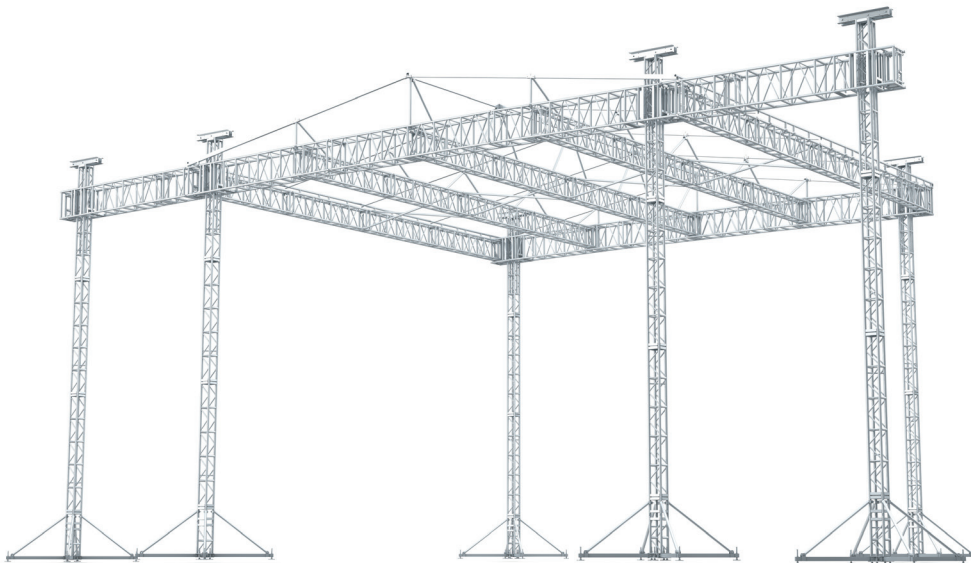

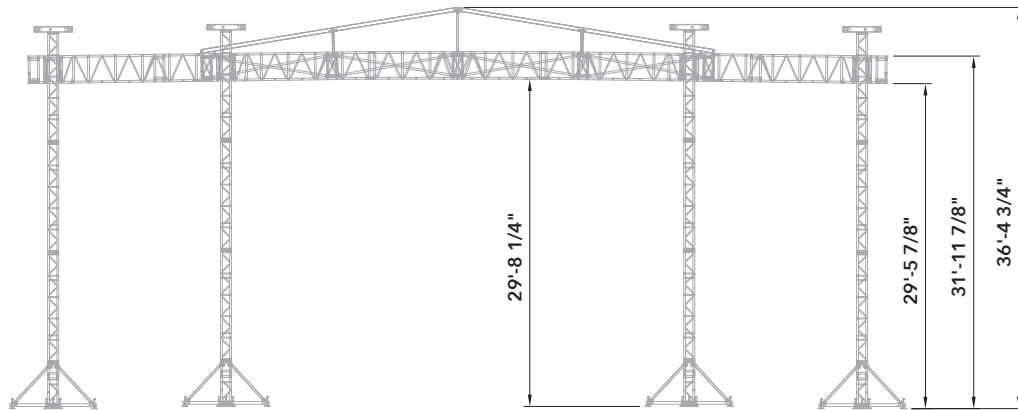

Elevation

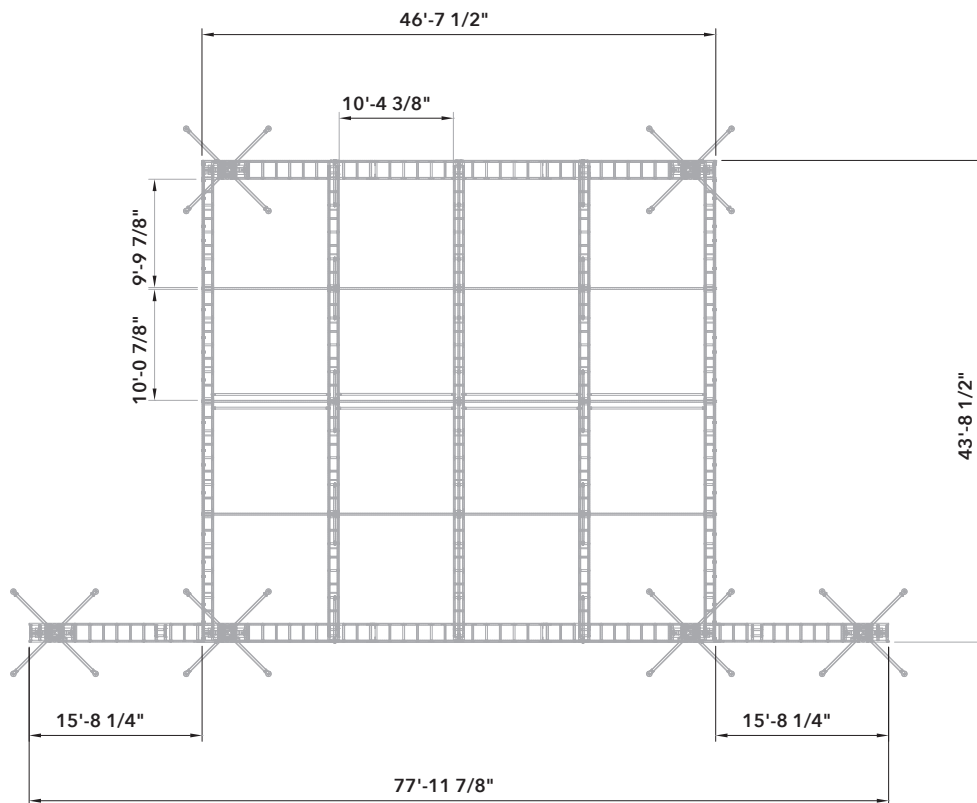

Plan