

# Outdoor roof systems

## 64 x 55 BFT with PA wings

The 64 x 55 BFT Roof System utilizes the same format components as the 64 x 40 BFT Roof and has an additional main cross stage truss span for support of larger productions. The general dimensions of this BFT is approximately 64' wide x 55' deep, not including the optional PA Wings shown here.

The maximum uniformly distributed load capacity for this BFT is approximately 65,000 pounds. It can also be customized to suit each customer's specific needs, which also includes being designed for permanent installations. Guy cables are required for temporary outdoor applications. Permanently installed BFT systems can be designed without the need for external guy cables, due to modifications carried out on the tower components.

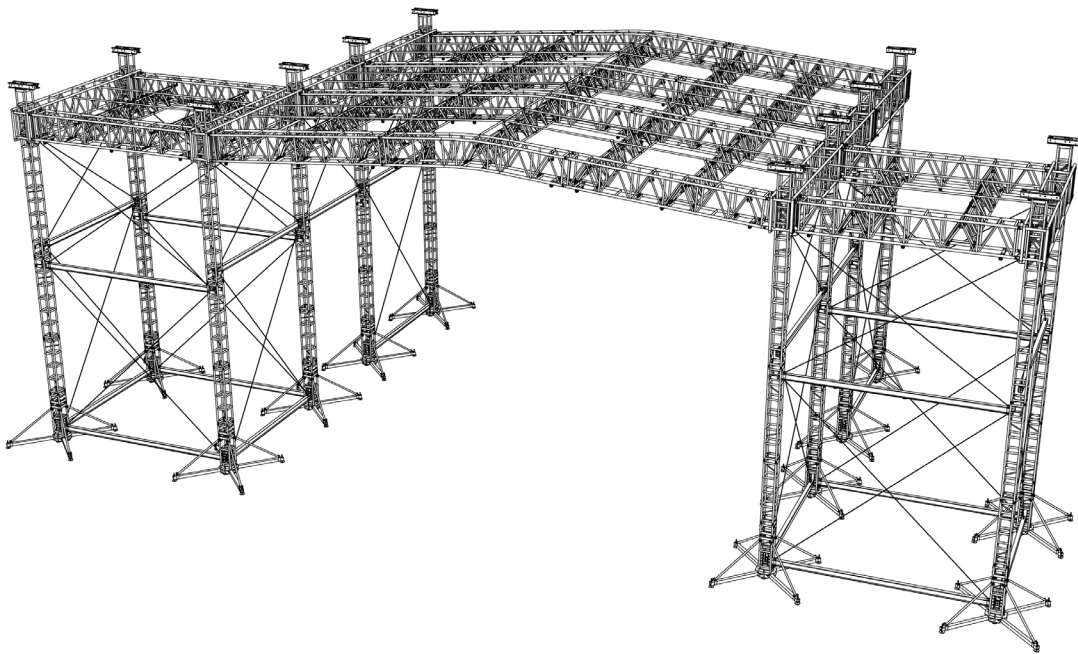

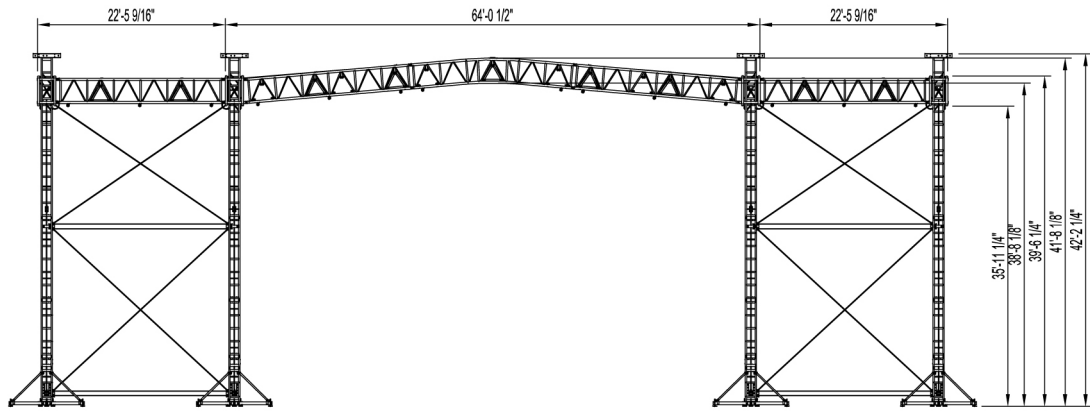

Elevation

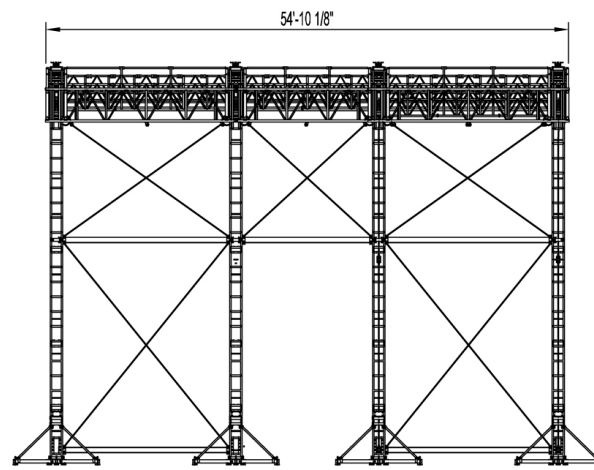

End View

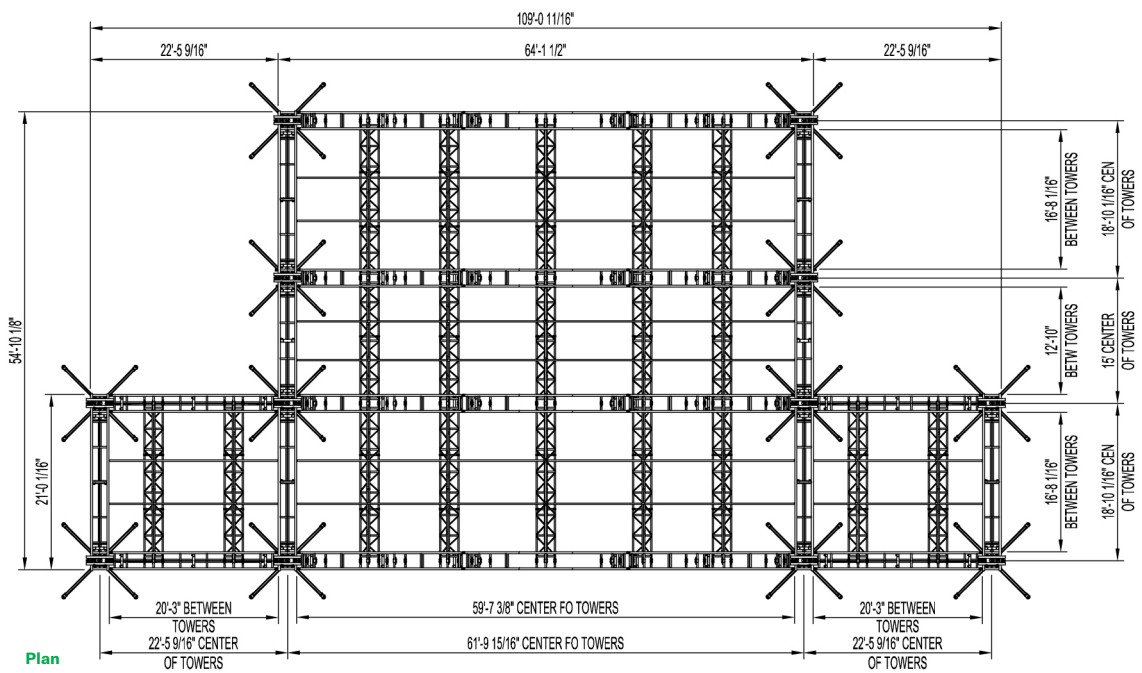

Plan