

# Triangle truss

## Folding triangle truss 26 spigoted

- › Folding triangle truss 26 spigoted
- › Standard lengths are 10', 8' and 5'
- › Custom lengths available upon request
- › Equipped with steel spigots
- › Main chords are 2" OD x 1/8" aluminum
- › Diagonals are 1" OD x 1/8" aluminum
- › Snap braces provided to lock truss in open position
- › Fabricated by AWS / SFL certified welders

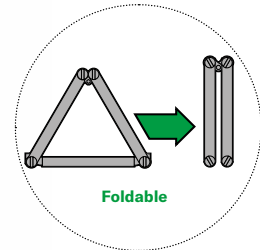

### Plan Views

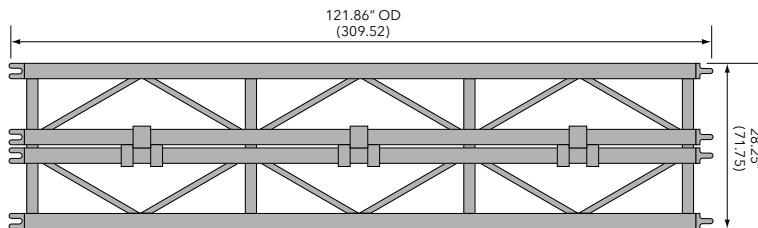

Plan

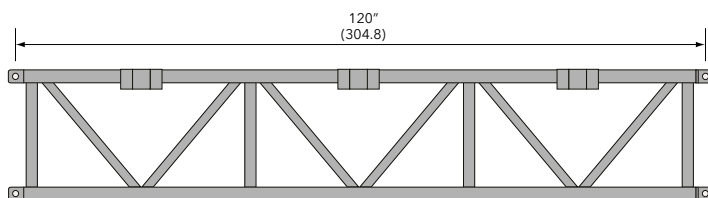
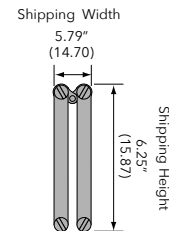

Elevation

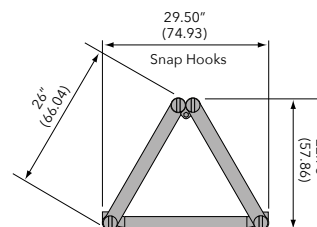

End View

## Loading chart

Span feet (meters)	Maximum allowable uniform loads			Maximum allowable point loads					
	Load lbs/ft	Load lbs (kgs)	Max Defl in.	center point	Max Defl. in.	third point	Max Defl. in.	quarter point	Load lbs (kgs)
10 (3.05)	546	5460 (2477)	0.04	5470 (2481)	0.06	2735 (1241)	0.05	1823 (827)	0.05
20 (6.09)	269	5380 (2440)	0.31	3812 (1729)	0.35	2692 (1221)	0.42	1795 (814)	0.39
30 (9.14)	164	4920 (2232)	0.98	2471 (1121)	0.80	1853 (841)	1.01	1235 (560)	0.94
40 (12.21)	88	3520 (1597)	1.74	1779 (807)	1.43	1334 (605)	1.79	889 (403)	1.68
50 (15.24)	53	2650 (1202)	2.71	1346 (611)	2.27	1010 (458)	2.80	673 (305)	2.63

Spigots Only

Note: Deflections reported in the tables on the left are the maximum expected for full loadings (indoor only). All loads are based on 10' (3.05 m) sections. Other section lengths are available. Load tables are reprinted from engineering reports developed by Parkhill, Smith & Cooper, Inc., Structural Engineers, and apply to truss fabricated after December 1989.

## Folding triangle truss 26 spigoted Connections are steel spigots & 3/4" clevis pins

Product Description	Item Code	Weight lbs (kgs)
5 FT FOLDING TRIANGLE TRUSS	TC 26FT-060S	60 (27)
8 FT FOLDING TRIANGLE TRUSS	TC 26FT-096S	84 (38)
10 FT FOLDING TRIANGLE TRUSS	TC 26FT-120S	92 (42)
3/4" CLEVIS PIN	TC CP-75	0.4 (0.18)
TOP HITCH PIN 3/4" x 4-3/4"	TC HP3/4X4-3/4	0.7 (0.32)
MEDIUM R-CLIP	TC RC-MED	- (-)