

# Outdoor roof systems

## 64 x 40 BFT with PA wings

Standing for "Big Frame Truss", this BTF roof design with PA wings is true to its name as it features 26" x 36" crossstage truss, 26" x 43" end truss and folding 26" triangle truss as the up-stage/down-stage part of the grid. The system utilizes 16" x 16" towers. The general dimensions of the BFT are 60' x 40' (18.29 m x 12.19 m), plus 20' x 20' PA wings on each side. It provides a safe operating wind speed of up to 67 mph and the live loads (equipment loads) that can be applied to the system include a 60,000 pound (27,216 kg) uniformly distributed load (UDL) on the main grid and a 24,000 pound (10,886 kg) speaker load on each PA Wing - making it the right choice for a range of applications.

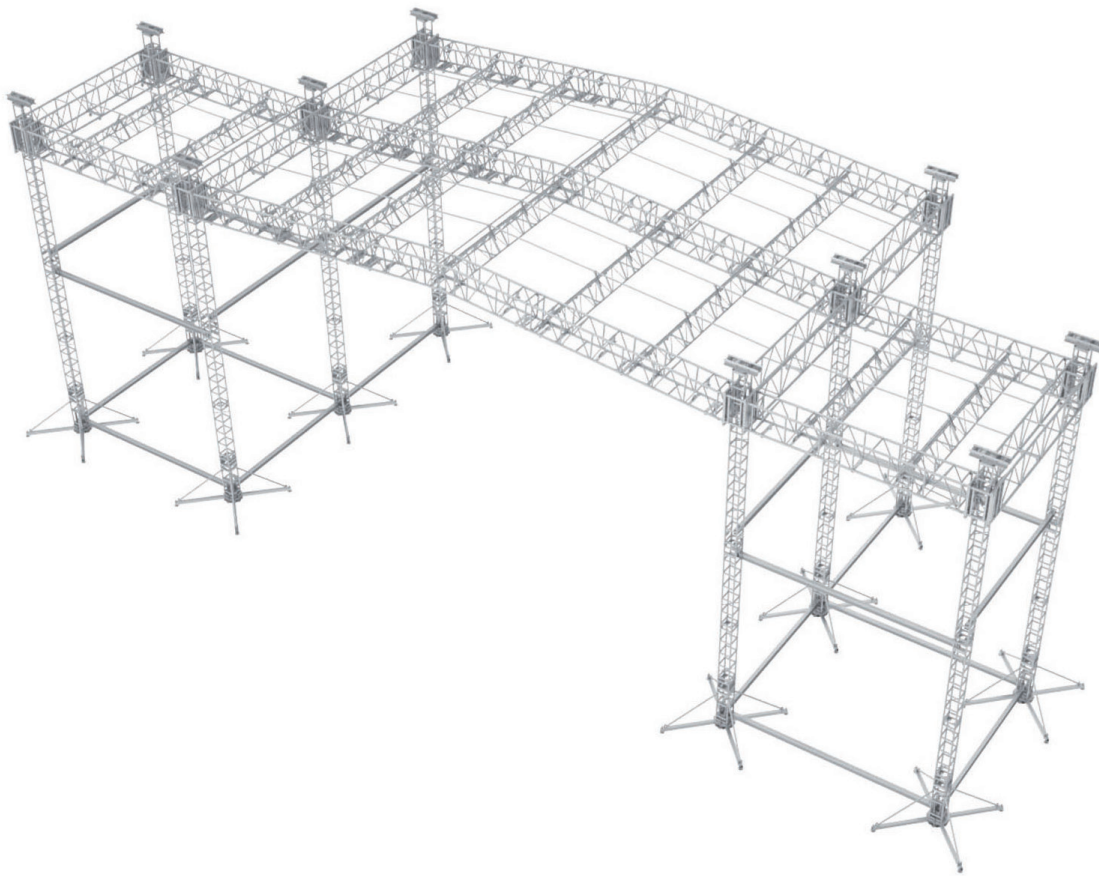

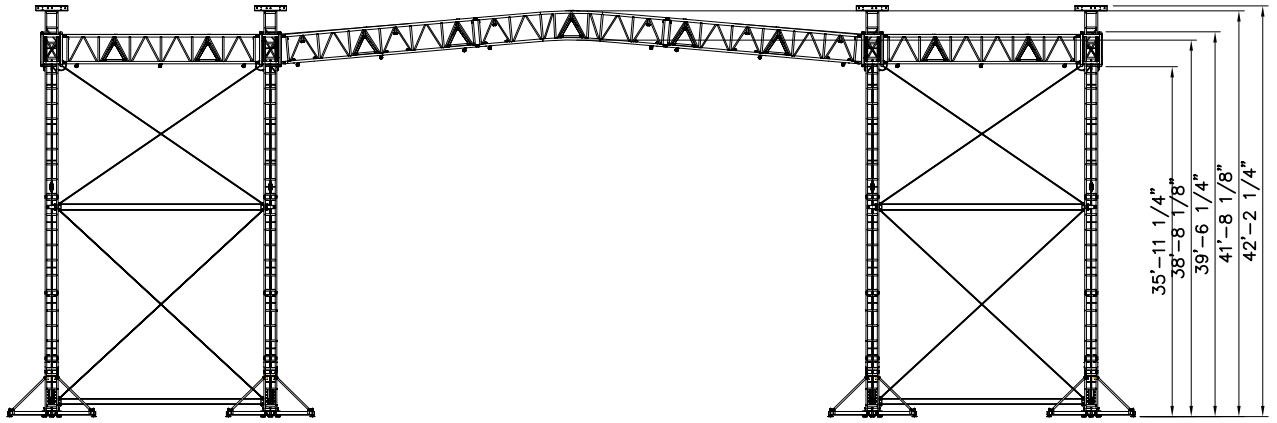

Elevation

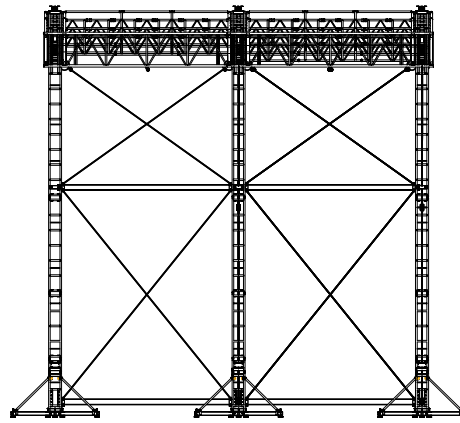

End View

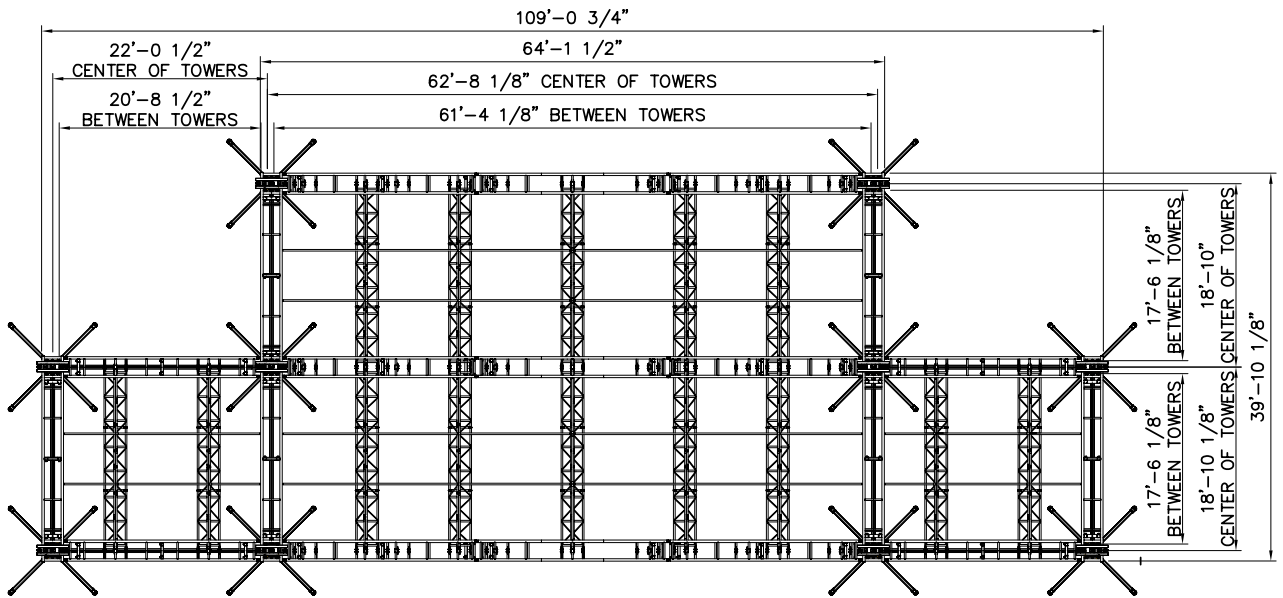

Plan